

TRAVEL TO THAILAND

STEP 1 - CHECK YOUR ELIGIBILITY: check if you are eligible to enter Thailand, in which category of permitted person are you and which type of visa you need to apply (*See details in attachment 1*)

STEP 2 - APPLY FOR VISA: a VALID visa or re-entry permit will be required in order to apply for a Certificate of Entry (COE). (*Apply visa through www.thaivisa.go.th*)

STEP 3 - APPLY FOR CERTIFICATE OF ENTRY (COE): starting from 23 November 2020, all COE applicants are required to apply online at coethailand.mfa.go.th (*See manual in attachment 2*)

COE approval process:

- (1) => applicant registers + uploads visa and initial required documents
- (2) => waiting for pre-approval (*within 3 working days*)
- (3) => applicant uploads flight and ASQ confirmation (*within 15 days or else you have to start the application process over again*)
- (4) => waiting for final approval (within 3 working days)
- (5) => COE approved: applicant print COE from website

IMPORTANT NOTICE: applicant **MUST** submit COE application at least 7 working days before departure date and upload flight and ASQ confirmation at least 3 working days before departure date. An overall process will take 5 to 15 working days depending on the correctness of submitted documents. In case of providing unclear or invalid information/documents, applicant may have to re-apply for COE which will take longer processing duration.

FLIGHTS TO THAILAND: Travelers may enter Thailand by **repatriation flights** arranged by the Embassy or the Thai Consulate-Generals in China or by **semi-commercial flights**. For further details about semi-commercial flights such as operation schedule, airfares, and reservation procedures, please contact the airlines directly (*See [List of semi-commercial flights to Thailand in attachment 3](#)*)

UPON DEPARTURE AND ARRIVAL IN THAILAND: The traveler will be requested to present the following documents:

- (1) Valid Thai Visa / Re-Entry Permit
- (2) Certificate of Entry (COE)
- (3) Completed Declaration form
- (4) Medical certificate attesting that the traveler is fit to travel (Fit to Fly/Travel Health Certificate)

(5) Medical certificate with RT-PCR method laboratory result attesting that the traveler is free from COVID-19 issued no more than 72 hours before travelling.

(6) Confirmed booking of 14-day Alternative State Quarantine (ASQ) or Alternative Hospital Quarantine (AHQ).

(7) Health insurance policy with a minimum coverage of USD 100,000 covering treatment and medical expenses related to COVID-19 during stay in Thailand.

* All documents MUST be in English or foreign language with official Thai translation

Disease Prevention Measures: Please kindly informed that upon arrival into Thailand, the non-Thai visitors will be subject to 14-days Alternative State Quarantine (ASQ) with their own expenses and will be requested to comply with relevant disease prevention measures prescribed by the Government of Thailand.

**List of permitted persons to enter Thailand under Section 9 of the Emergency Decree on
Public Administration in Emergency Situations**

Category	Description	VISA TYPE
(3)	Persons on diplomatic or consular missions or under International organizations, or representatives of foreign governments or agencies performing their duties in Thailand, or any other persons in international agencies, that the Ministry of Foreign Affairs gives permission pertaining to necessity, including their spouse, parents, or children	Diplomatic
(6)	Non-Thai nationals who are spouses, parents, or children of Thai nationals	Non- Immigration O
(7)	Non-Thai nationals who have a certificate of residence, or have been permitted to take up residency in the Kingdom	
(8)	Non-Thai nationals who have a work permit or have been granted permission to work in the Kingdom in accordance with Thai laws, including their spouses or children	- Non- Immigration B - Non- Immigration O (for spouse/ children)
(9)	Non-Thai nationals who are students of educational establishments in Thailand approved by Thai authorities, including their parents or guardians, except for students of non-formal schools in accordance with laws on private schools or of any other similar private educational establishments	- Non- Immigration ED - Non- Immigration O (for parent or guardian)
(10)	Non-Thai nationals who need to receive medical treatment in Thailand, including their accompanying persons, except for treatment for COVID-19	- TR-MT - Non- Immigration O (staying more than 60 days)
(11)	<p>Non-Thai nationals who are permitted to enter the Kingdom under a special arrangement with a foreign country or have been granted permission by the Prime Minister.</p> <ul style="list-style-type: none"> - (11-Elite) holder of Thailand Elite visa (* please contact Thailand Privilege Co., Ltd. for a registration before apply for COE from the Embassy) - (11-OA/OX) holder of Long Stay (O-A) or Long Stay 10 years (O-X) visa (Retirement visa) - (11-APEC) holder of APEC Card (only for Chinese nationals) - (11-STV) holder of Special Tourist Visa (STV) - (11-TR) holder of Tourist Visa (TR) - (11-Non-B) holder of Non-Immigrant Visa B (visiting Thailand for business/investment purpose) 	

Certificate of Entry (COE) Registration Guideline for Non-Thai Nationals

Announcement

This registration is the application of Certificate of Entry (COE) only. The system is not related to visa application. If you have yet to receive a valid Thai visa, please contact Royal Thai Embassy or Royal Thai Consulate-General in your area for visa application at least 7 – 15 working days before the expected date of travel. For more inquiries, please visit official website of Royal Thai Embassy or Royal Thai Consulate-General where you intend to apply.

Before registration, applicants should prepare files of required documents in .pdf or .jpeg version to upload to the system. The list of required documents for each category of eligible persons* can be found in the next section.

The registration will be divided into 2 parts as follows:

(1) Pre-approval:

- Applicants fill in personal information and upload required documents into the system to prove eligibility to enter Thailand.

Thai visa

- If you have a valid Thai visa, you are recommended to upload it into the system.
- If you have yet to receive a valid Thai visa, please contact Royal Thai Embassy or Royal Thai Consulate-General for visa application. However, you can also apply for the COE prior obtaining a visa, but you may be requested to upload a valid Thai visa before COE issuance.

Medical insurance (including medical costs in the event that applicant contracts COVID-19, which must cover the total duration of stay in Thailand)

- If you have a medical insurance, you should upload it into the system.
 - If you do not have a medical insurance yet, you can upload it later, together with the plane ticket and the Alternative State Quarantine (ASQ) booking confirmation.
 - To facilitate foreigners travelling to Thailand, Thai General Insurance Association (TGIA) and Thai Life Assurance Association (TLAA) are cooperating with Thailand's 16 leading life and non-life insurance companies under the regulation of the Office of Insurance Commission (OIC) to offer COVID-19 Insurance Protection Program which its terms and conditions are covering requirement of Thai government. For more inquiries, please visit <http://covid19.tgia.org>.
- After the submission of their applications, the applicants will be given a 6-digit reference code. The code will be used to track your registration status and to download the COE.
- Royal Thai Embassy and Royal Thai Consulate-General will pre-approve your application within 3 working days.
- The applicants are able to edit your information at “Edit information” and track your registration status at “Check the result”.

(2) Issuance of COE:

- After your application has been pre-approved, the applicants should buy air ticket and book ASQ. For more ASQ information, please visit www.hsscovid.com.
- Go to “Confirm trip” menu and provide your flight detail, plane ticket, ASQ booking confirmation on your arrival date, and medical insurance (if the applicants have not provided it in pre-approved stage) and upload the above-mentioned documents into the system within 15 days after your application has been pre-approved.
- If you do not submit the required documents within 15 days, the system will automatically delete your application, which you have to start the application process over again.
- Royal Thai Embassy and Royal Thai Consulate-General will issue a COE within 3 working days after the applicants have submitted travel information.
- The applicants can check your registration status at “Check the result” menu. If your COE is granted, you can download the COE directly from the registration website.

For more inquiries, please read COE Registration Guideline at coethailand.mfa.go.th or contact Royal Thai Embassy and Royal Thai Consulate-General near you.

After COE issuance, please ensure that you have the following documents to present at the check-in counter and to the Department of Disease Control’s Representatives upon arrival into Thailand.

- (1) Passport
 - (2) Certificate of Entry (COE)
 - (3) Fit to Fly Health Certificate. (Thailand’s Health Control required a hard copy version.)
 - (4) Medical certificate with a laboratory result indicating that COVID-19 is not detected, using RT-PCR test, issued within 72 hours before departure (in case of connecting flights, before embarkation from initial port).
 - (5) (For the Department of Disease Control upon arrival into Thailand only) Medical insurance or letter from employer guaranteeing that the insurance company or employer will cover a minimum of 100,000 USD of medical costs incurred by the applicant in Thailand, including medical costs in the event that applicant contracts COVID-19 (The insurance must cover the total duration of stay in Thailand)
 - (6) T.8 Form (Thailand’s Health Declaration Form). You can download T.8 Form at shorturl.at/IQYZ7.
- **DOCUMENTS (3) (4) (5) MUST BE IN ENGLISH OR THAI ONLY. CERTIFIED TRANSLATIONS INTO ENGLISH OR THAI ARE ACCEPTED IN THE CASE THAT THE ORIGINAL COPY IS IN A FOREIGN LANGUAGE.**
 - **DOCUMENT (5) NEEDS TO BE QUOTED IN US DOLLARS. OTHER CURRENCIES WILL NOT BE ACCEPTED BY THE DEPARTMENT OF DISEASE CONTROL.**

* * * * *

*By virtue of Section 9 of the Emergency Decree on Public Administration in Emergency Situations B.E. 2548 (2005) and Section 11 of the State Administration Act B.E. 2534 (1991), the entry to Thailand is permitted for particular persons in the exempted list. The list for non-Thai nationals includes the following:

(1) Exempted persons or persons who are specified, permitted or invited by the Prime Minister or Chief official responsible for remedying the emergency situation to enter into the Kingdom pertaining to necessity, whereby conditions and time frames may also be prescribed;

(2) Persons on diplomatic or consular missions or under International organizations, or representatives of foreign governments or agencies performing their duties in Thailand, or any other persons in international agencies, that the Ministry of Foreign Affairs gives permission pertaining to necessity, including their spouse, parents, or children; (click here for more information)

(3) Non-Thai nationals who are spouses, parents, or children of Thai nationals (click here for more information)

(4) Non-Thai nationals who have a certificate of residence, or have been permitted to take up residency in the Kingdom; (click here for more information)

(5) Non-Thai nationals who have a work permit or have been granted permission to work in the Kingdom in accordance with Thai laws, including their spouses or children; (click here for more information)

(6) Non-Thai nationals who are students of educational establishments in Thailand approved by Thai authorities, including their parents or guardians, except for students of non-formal schools in accordance with laws on private schools or of any other similar private educational establishments; (click here for more information)

(7) Non-Thai nationals who need to receive medical treatment in Thailand, including their accompanying persons, except for treatment for COVID-19 (click here for more information)

(8) Non-Thai nationals who are permitted to enter the Kingdom under a special arrangement with a foreign country or have been granted permission by the Prime Minister – all of whom must strictly adhere to the Kingdom's communicable disease prevention and control measures.

List of documents to upload on registration system for Royal Thai Embassy/ Consulate-General consideration

Category of non-Thai nationals permitted to enter Thailand*	Exempted Category	Required documents for pre-approved registration (All documents must be in English or have a certified translation)	Required documents for COE issuance
<p>Exempted Persons Exempted persons or persons who are specified, permitted or invited by the Prime Minister or Chief official responsible for remedying the emergency situation to enter into the Kingdom pertaining to necessity, whereby conditions and time frames may also be prescribed</p>	2	Please contact the Ministry of Foreign Affairs of Thailand or Royal Thai Embassy or Royal Thai Consulate-General.	
<p>Diplomats and International Organizations Officers Persons on diplomatic or consular missions or under International organizations, or representatives of foreign governments or agencies performing their duties in Thailand, or any other persons in international agencies, that the Ministry of Foreign Affairs gives permission pertaining to necessity, including their spouse, parents, or children</p>	3	<p>1. Copy of passport 2. Copy of Thai visa If the applicant does not have a valid visa, the applicant must submit the following original documents directly to the Embassy / Consulates-General to request the issuance of an appropriate visa (if required) 3. An official Note issued by the Ministry of Foreign Affairs of that country or International Organization. 4. A letter from the Ministry of Foreign Affairs of that country/ International Organization affirming that the Embassy/ International Organization responsible for healthcare or medical treatment expenses including COVID-19.</p>	<p>- Flight confirmation - ASQ / OQ confirmation on arrival date or equivalent documents</p>
<p>Family of Thai Nationals Non-Thai nationals who are spouses, parents, or children of Thai nationals</p>	6	<p>1. Copy of passport 2. Copy of valid Thai visa or re-entry permit (If visa/re-entry permit has already expired, please apply for a new one) 3. Copy of spouse's / parent's Thai passport or Thai Identification card. 4. Proof of relationship with Thai nationals, such as a copy of marriage certificate or birth certificate.</p>	<p>- Flight confirmation - ASQ confirmation on arrival date</p>

Category of non-Thai nationals permitted to enter Thailand*	Exempted Category	Required documents for pre-approved registration (All documents must be in English or have a certified translation)	Required documents for COE issuance
		5. Medical insurance or letter from employer guaranteeing that the insurance company or employer will cover a minimum of 100,000 USD of medical costs incurred by the applicant in Thailand, including medical costs in the event that applicant contracts COVID-19 (The insurance must cover the total duration of stay in Thailand)	
Certificate of Residence Holders Non-Thai nationals who have a certificate of residence, or have been permitted to take up residency in the Kingdom, including their spouses or children	7	1. Copy of passport 2. Copy of valid Thai visa or re-entry permit (If visa/re-entry permit has already expired, please apply for a new one) 3. Copy of Certificate of Residence 4. Medical insurance or letter from employer guaranteeing that the insurance company or employer will cover a minimum of 100,000 USD of medical costs incurred by the applicant in Thailand, including medical costs in the event that applicant contracts COVID-19 (The insurance must cover the total duration of stay in Thailand)	- Flight confirmation - ASQ confirmation on arrival date
Work Permit Holders Non-Thai nationals who have a work permit or have been granted permission to work in the Kingdom in accordance with Thai laws, including their spouses or children	8	For work permit holder 1. Copy of passport 2. Copy of valid Thai visa or re-entry permit (If visa/re-entry permit has already expired, please apply for a new one) 3. Copy of a valid work permit or letter from relevant Thai authority confirming permission to work in Thailand (letter confirming approval of WP.3, approval letter from BOI, or approval letter from IEAT) 4. (if spouse or children will accompany a work permit holder) 4.1 Copy of passport of your spouses or children 4.2 Copy of official documents as proof of relationship, such as marriage certificate, or birth certificate.	- Flight confirmation - ASQ confirmation on arrival date

Category of non-Thai nationals permitted to enter Thailand*	Exempted Category	Required documents for pre-approved registration (All documents must be in English or have a certified translation)	Required documents for COE issuance
		<p>5. Medical insurance or letter from employer guaranteeing that the insurance company or employer will cover a minimum of 100,000 USD of medical costs incurred by the applicant in Thailand, including medical costs in the event that applicant contracts COVID-19 (The insurance must cover the total duration of stay in Thailand)</p> <p>For spouse or children of a work permit holder</p> <ol style="list-style-type: none"> 1. Copy of passport 2. Copy of valid Thai visa or re-entry permit (If visa/re-entry permit has already expired, please apply for a new one) 3. Copy of passport of work permit holder 4. Copy of a valid work permit of work permit holder or letter from relevant Thai authority confirming permission to work in Thailand (letter confirming approval of WP.3, approval letter from BOI, or approval letter from IEAT) 5. Copy of official documents as proof of relationship, such as marriage certificate, or birth certificate. 6. Medical insurance or letter from employer guaranteeing that the insurance company or employer will cover a minimum of 100,000 USD of medical costs incurred by the applicant in Thailand, including medical costs in the event that applicant contracts COVID-19 (The insurance must cover the total duration of stay in Thailand) 	
<p>Students Non-Thai nationals who are students of educational establishments in Thailand approved by Thai authorities, including their parents or guardians, except for students of non-formal schools in accordance</p>	9	<p>For student</p> <ol style="list-style-type: none"> 1. Copy of passport 2. Copy of valid Thai visa or re-entry permit (If visa/re-entry permit has already expired, please apply for a new one) 3. Copy of letter confirming enrollment or admission 	<p>- Flight confirmation - ASQ confirmation on arrival date</p>

Category of non-Thai nationals permitted to enter Thailand*	Exempted Category	Required documents for pre-approved registration (All documents must be in English or have a certified translation)	Required documents for COE issuance
<p>with laws on private schools or of any other similar private educational establishments (This category DOES NOT include students of non-formal schools in accordance with laws on private schools or other similar private educational establishments.)</p>		<p>4. (If parents or guardians will accompany a student) 4.1 Copy of passport of your parents or guardians 4.2 Copy of official documents as proof of relationship, such as marriage certificate, or birth certificate 5. Medical insurance or letter from employer guaranteeing that the insurance company or employer will cover a minimum of 100,000 USD of medical costs incurred by the applicant in Thailand, including medical costs in the event that applicant contracts COVID-19 (The insurance must cover the total duration of stay in Thailand)</p> <p>For parents or guardians of a student 1. Copy of passport 2. Copy of valid Thai visa or re-entry permit (If visa/re-entry permit has already expired, please apply for a new one) 3. Copy of passport of student 4. Copy of letter confirming the student's status or admission of the student. 5. Copy of official document proving the relationship with the student as his/her parent or guardian, such as birth certificate. 6. Medical insurance or letter from employer guaranteeing that the insurance company or employer will cover a minimum of 100,000 USD of medical costs incurred by the applicant in Thailand, including medical costs in the event that applicant contracts COVID-19 (The insurance must cover the total duration of stay in Thailand)</p>	

Category of non-Thai nationals permitted to enter Thailand*	Exempted Category	Required documents for pre-approved registration (All documents must be in English or have a certified translation)	Required documents for COE issuance
<p>Foreigners with Medical Appointment Non-Thai nationals who need to receive medical treatment in Thailand, including their accompanying persons, except for treatment for COVID-19</p>	10	<p>For patient</p> <ol style="list-style-type: none"> 1. Copy of passport 2. Copy of valid Thai visa or re-entry permit (If visa/re-entry permit has already expired, please apply for a new one) 3. Financial statement showing that the applicant is able to take responsibility for all of the treatment expenses and any other expenses that may be incurred during the stay in Thailand 4. Copy of confirmation letter for Alternative Hospital Quarantine (DHSS/AHQ 1) with stamp of approval from Ministry of Public Health 4. Medical insurance or letter from employer guaranteeing that the insurance company or employer will cover a minimum of 100,000 USD of medical costs incurred by the applicant in Thailand, including medical costs in the event that applicant contracts COVID-19 (The insurance must cover the total duration of stay in Thailand) <p>**One patient is allowed a maximum of 3 accompanying persons who must be quarantined at the same hospital as the patient and the period of their stay in Thailand needs to be at least 14 days**</p> <p>For an accompanying person</p> <ol style="list-style-type: none"> 1. Copy of passport 2. Copy of valid Thai visa or re-entry permit (If visa/re-entry permit has already expired, please apply for a new one) 3. Copy of passport of patient 4. Patient's copy of confirmation letter for Alternative Hospital Quarantine (DHSS/AHQ 1) with stamp of approval from Ministry of Public Health 	<ul style="list-style-type: none"> - Flight confirmation - AHQ confirmation

Category of non-Thai nationals permitted to enter Thailand*	Exempted Category	Required documents for pre-approved registration (All documents must be in English or have a certified translation)	Required documents for COE issuance
		5. Affidavit of Support with stamp of approval form Ministry of Public Health 6. Medical insurance or letter from employer guaranteeing that the insurance company or employer will cover a minimum of 100,000 USD of medical costs incurred by the applicant in Thailand, including medical costs in the event that applicant contracts COVID-19 (The insurance must cover the total duration of stay in Thailand)	
Foreigners under a Special Arrangement or have been granted permission by the Prime Minister Non-Thai nationals who are permitted to enter the Kingdom under a special arrangement with a foreign country or have been granted permission by the Prime Minister. As of 21 October 2020, this consists of the following groups: (1) Approved Thailand Elite Member ¹ (2) APEC Card Holder ² (3) Long Stay Visitor - Non-Immigrant O-A Visa Holder ³ - Non-Immigrant O-X Visa Holder ⁴	11	1. Copy of passport 2. Copy of valid Thai visa or re-entry permit (if required) (If visa/re-entry permit has already expired, please apply for a new one) 3. Medical insurance or letter from employer guaranteeing that the insurance company or employer will cover a minimum of 100,000 USD of medical costs incurred by the applicant in Thailand, including medical costs in the event that applicant contracts COVID-19 (The insurance must cover the total duration of stay in Thailand) 4. Additional required documents 4.1 Thailand Elite Member - Letter from Thailand Privilege Card Co., Ltd., or the Ministry of Tourism and Sports or relevant government agencies.	- Flight confirmation - ASQ confirmation on arrival date

¹ Thailand Elite Member should contact Thailand Privilege Card Co., Ltd to check eligibility to enter Thailand. Thai Embassy/ Consulate-General will issued COE to a person whose named is in a list submitted by Thailand Privilege Card Co., Ltd., Ministry of Tourism and Sports or relevant government agencies.

² APEC Card holder must travel from a member economy where he/she holds citizenship (eligible member economies: Australia, China, Hong Kong, Japan, Malaysia, New Zealand, Singapore, South Korea, Taiwan and Vietnam), and is permitted to stay in Thailand for 90 days.

³ The applicant must be a foreigner age of 50 and over who have a permanent residence in a country in which the application is submitted. Holder of Non-Immigrant O-A visa is allowed to stay in Thailand for 1 year. Employment of any kind is strictly prohibited.

⁴ The applicant must be an ordinary passport holder with a nationality of Japan, Australia, Denmark, Finland, France, Germany, Italy, the Netherlands, Norway, Sweden, Switzerland, the United Kingdom, Canada, and the United States of America, with the age of 50 years old and over, including spouse and child (age under 20 years old). Holder of Non-Immigrant O-X visa is allowed to stay in Thailand for 5 years each time (total 10 years). Employment of any kind is strictly prohibited.

Category of non-Thai nationals permitted to enter Thailand*	Exempted Category	Required documents for pre-approved registration (All documents must be in English or have a certified translation)	Required documents for COE issuance
(4) Medium-Term Visitor - Tourist-TR Visa Holder (single entry) ⁵ - Businessman and Investor ⁶ (Non-Immigrant B Visa Holder) (5) Special Tourist Visa (Tourist-STV) Holder ⁷ (6) Approved Film Crew Member *For more inquiries about Thai visa, please visit https://thaievisa.go.th		4.2 APEC Card Holder - APEC card 4.3 Long Stay Visitor - Certificate of Residence (if any) 4.4 Special Tourist Visa Holder - Receipt or the proof of payment for at least 14 days of staying in ASQ or AHQ 4.5 Film Crew Member - Copy of a permit letter issued by the Thailand Film Office, Department of Tourism, Ministry of Tourism and Sports of Thailand	

* * * * *

⁵ Tourist Visa (TR) holder is permitted to stay in Thailand for 60 days and can apply for a 30-day extension.

⁶ A non-Immigrant B visa holder is permitted to stay in Thailand for 90 days. Applicant must have an invitation letter from a Thai company with a registered capital not less than 2 million THB or evidence showing ownership of a condominium/ deposit in a Thai bank/ Thai government bond with face value not less than 3 million THB.

⁷ Applicant for STV must reside in the country with a low-rate of confirmed COVID-19 cases as determined fortnightly and officially by Announcement of the Ministry of Public Health of Thailand. STV visa holder is allowed to stay in Thailand for 90 days and the STV can be extended 2 times, 90 days each.

Certificate of Entry (COE) Registration Guideline

The steps shown within this document is an example of the registration process.
All personal detail, document code and contact information displayed are suppositions only.

1. Pre-approval Registration

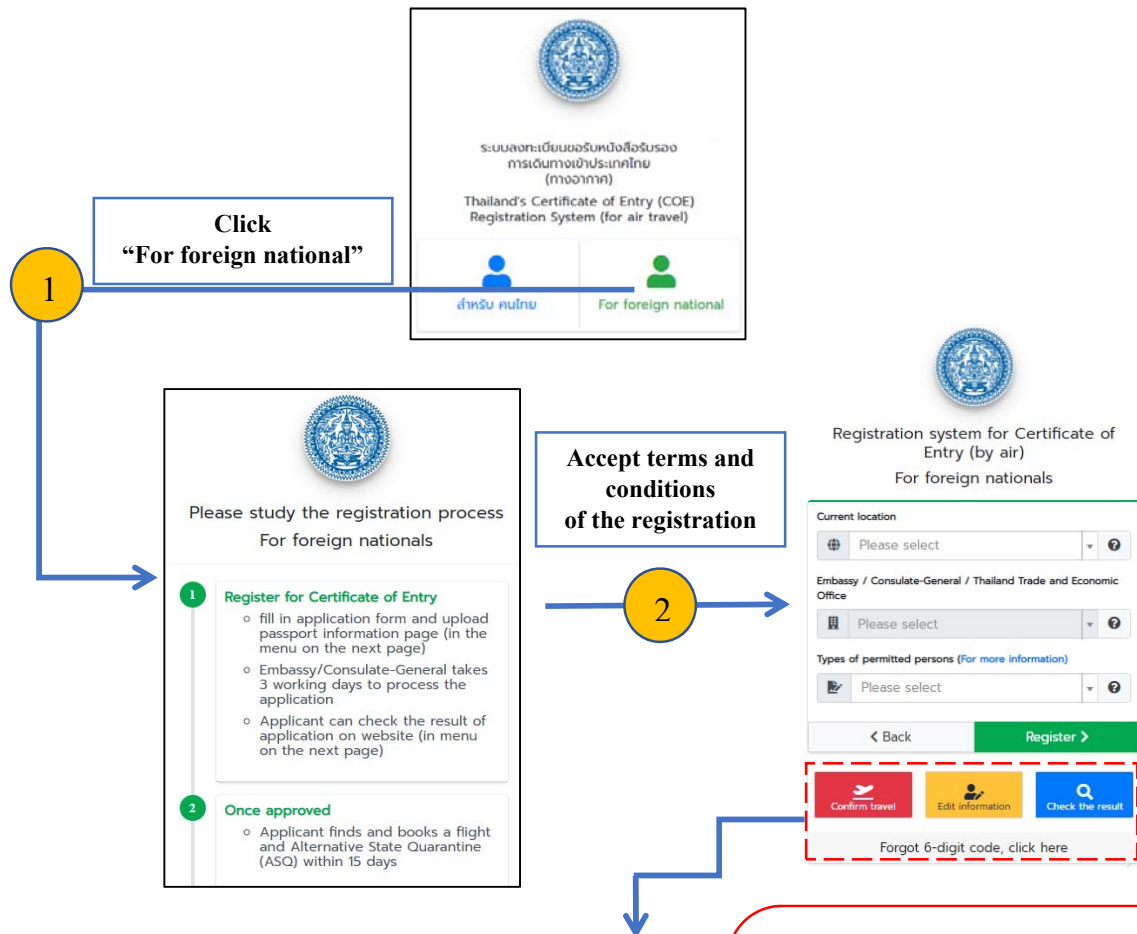

Key menu instructions

- **Confirm travel**
For document attachment
- **Edit information**
For modification of the registration information
- **Check the result**
For checking the result and download the approved COE
- **Forgot 6-digit code**
For recalling the 6-digit code

After registered, fill in personal information in the provided form

The registration system interface shows the following fields: Current location, Embassy / Consulate-General / Thailand Trade and Economic Office, and Types of permitted persons. The 'Personal Information' form includes: Title (Eng), Name (English), Middle name (English), Surname (English), and Position. A note states: 'If there is no choice for selection, applicant can fill in the information manually'.

Required documents

1. Passport
2. Additional documents (according to the type of person intended to enter Thailand)
3. Medical insurance (including medical costs in the event that applicant contracts COVID-19, which must cover the total duration)

After all the information are filled in, the system will generate 6-digit code which will be used until the receipt of COE.

The 'Saving information complete' screen displays the message: 'The System has transmitted the application to relevant Embassy/Consulate-General. Please keep this code for obtaining the Certificate of Entry.' The 6-digit code is **970186**.

The 'Very important' section states: 'Royal Thai Embassy/Consulate-General will pre-approve your documents within 3 working days. After you are pre-approved, please upload your plane ticket, ASQ booking confirmation and other required documents (if any) within 15 days.' It also provides the URL: go to coethailandmfa.go.th at the Confirmation of Travel Menu.

Please note that :

- Air ticket and Alternative State Quarantine (ASQ) booking confirmation must be uploaded to the system within 15 days after your application has been pre-approved.
- If failed to upload the above, the system will automatically cancel your application, and the applicant must start registration process again.

2. Travel confirmation

1

Confirm travel Edit information Check the result

Forgot 6-digit code, click here

Please fill in information for confirmation
Only for air travelers

PASSPORT NUMBER

FIRST NAME

LAST NAME

6-digit code obtained after registration

2 Search Close

3

Attach the evidence of your flight reservation (photo or PDF file of flight reservation)

When your registration is complete, please upload the evidence of your flight reservation within 15 days.

You have time to left

Day	Hour	Minutes	Second
14	23	55	38

Flight number

* Example: 16999

Date of Departure

Date of Arrival

After submit travel itinerary, the Royal Thai Embassy and Royal Thai Consulate-General will issue a COE within 3 working days.

3. Information modification and tracking the approval result

- The applicants are able to edit personal information at “**Edit information**” and track registration status at “**Check the result**”.

Please fill in information for verification

PASSPORT NUMBER

FIRST NAME

LAST NAME

6-digit code obtained after registration

Search Close

Approval status

Waiting for approval
Your application is under consideration
OK

Approved
Click Download button below to obtain Certificate of Entry
Download

Please note that :

- The information can be modified only
 - When the registration is completed and the embassy/ consulate-general has yet to approve the submitted application, or
 - When the embassy/ consulate-general has rejected the application but allow applicant to modify the information.
- The COE can be received at the “Download” button.

4. The recall of the 6-digit code

In case the applicant forgets the given 6-digit code, it can be recalled as follows.

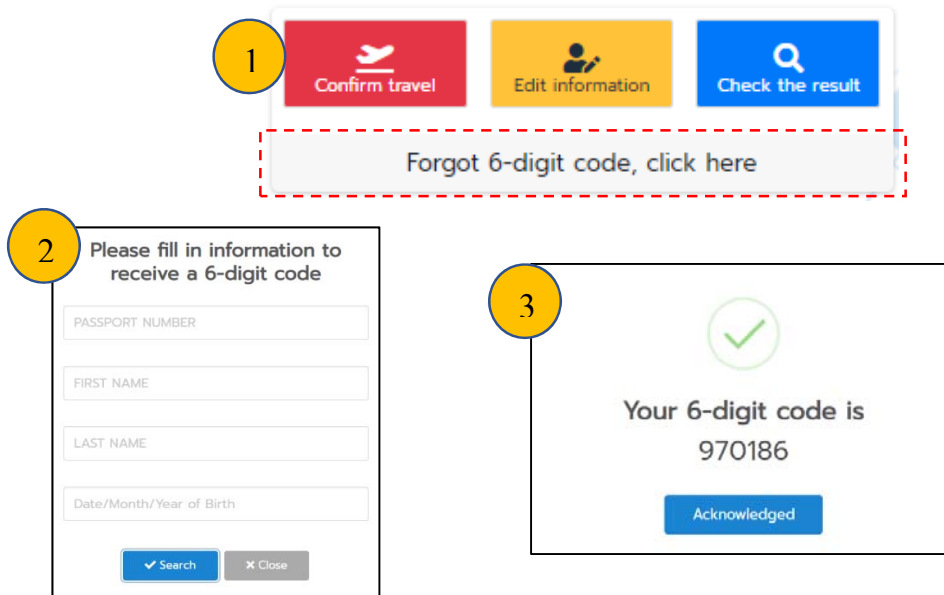

5. Entry to Thailand

5.1 After the receipt of COE, please prepare the additional documents to **declare at the check-in counter** as follows.

- (1) **Passport and valid Thai visa/ re-entry permit** (if required)
 - (2) **Certificate of Entry (COE)**
 - (3) **Fit to Fly Health Certificate.** (Thailand's Health Control requires a hard copy version.)
 - (4) **Medical certificate with a laboratory result indicating that COVID-19 is not detected, using RT-PCR test, issued within 72 hours before departure** (in case of connecting flights, before embarkation from initial port).
 - (5) Insurance or letter from employer guaranteeing that the insurance company or employer will cover a minimum of 100,000 USD of medical costs incurred by the applicant in Thailand, including medical costs in the event that applicant contracts COVID-19 (The insurance must cover the total duration of stay in Thailand)
 - (6) T.8 Form (Health Declaration Form). You can download T.8 Form at shorturl.at/1QYZ7.
- Documents (3) (4) (5) must be in English or Thai only. Certified translations into English or Thai are accepted in the case that the original copy is in a foreign language.

5.2 The abovementioned documents in 5.1 must be declared to the immigration and disease control officers once the passenger has arrived in Thailand.

Note: If encounter any problem during the registration, please contact the embassy/ consulate-general which the applicant has registered in the form.

* * * * *

List of semi-commercial flights to Thailand in December 2020

Airlines	Flight No.	Route
Thai Smile	WE685	CKG-BKK
Spring Airlines	9C6465	PVG-BKK
China Southern Airlines	CZ3081	CAN-BKK
Lucky Air	8L801	KMG-BKK
China Eastern Airlines	MU541	PVG-BKK
Shanghai Airlines	FM833	PVG-BKK
Air China	CA979	PEK-BKK
Juneyao Air	HO1357	PVG-BKK
Shenzhen Airlines	ZH9003	SZX-BKK
Thai Air Asia	FD327	NKG-DMK
	FD541	CSX-DMK
9 Air	AQ1007	CAN-BKK
Sichuan Airlines	3U8145	CTU-BKK
Xiamen Airlines	MF833	XMN-BKK