

TRAVELLING TO THAILAND (For All Non-Thai Nationals)
Starting from 20 November 2020

STEP 1 – CHECK YOUR ELIGIBILITY : check if you are eligible to enter Thailand, to which category of permitted person you belong and which type of visa you need to apply for (**see attachment**)

STEP 2 – APPLY FOR VISA : a VALID Thai visa or re-entry permit will be required in order to apply for a Certificate of Entry (COE). If you need to apply for a Thai visa, please apply online at **www.thaievisa.go.th**

STEP 3 – APPLY FOR CERTIFICATE OF ENTRY (COE) : starting from 20 November 2020, all COE applicants are required to apply online at **coethailand.mfa.go.th**

COE Approval Process:

- (1) Applicant registers + uploads a valid Thai visa or re-entry permit and required documents
- (2) Wait for pre-approval (within 3 working days)
- (3) Applicant uploads flights and ASQ confirmation (within 15 days)
- (4) Wait for final approval (within 3 working days)
- (5) COE granted and issued. Applicant downloads the COE directly from the registration website and prints out a copy.

IMPORTANT NOTICE: applicant **MUST** submit COE application at least 7 working days before departure date and upload flight and ASQ confirmation at least 3 working days before departure date. The overall process will take 5 to 15 working days depending on the completion of submitted documents. If any document is deemed invalid or unacceptable, applicant may have to re-apply for a new COE which will lengthen the approval process.

Certificate of Entry (COE) Registration Guideline

The steps shown within this document is an example of the registration process.
All personal detail, document code and contact information displayed are suppositions only.

1. Pre-approval Registration

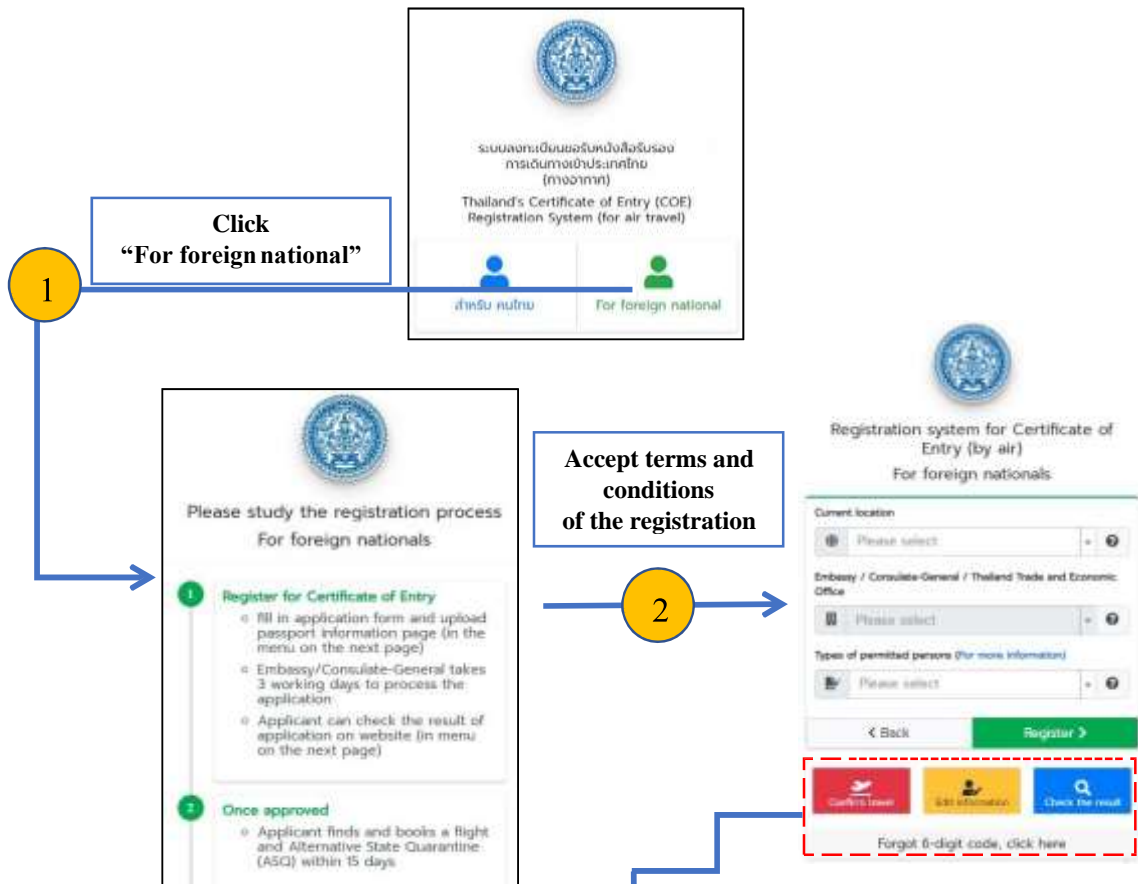

Key menu instructions

- ☐ **Confirm travel**
For document attachment
- ☐ **Edit information**
For modification of the registration information
- ☐ **Check the result**
For checking the result and download the approved COE
- ☐ **Forgot 6-digit code**
For recalling the 6-digit code

After registered, fill in personal information in the provided form

Registration system for Certificate of Entry (by air)
For foreign nationals

Current location
Please select

Embassy / Consulate-General / Thailand Trade and Economic Office
Please select

Types of permitted persons (for more information)
Please select

< Back Register >

Forgot 6-digit code, click here

Personal Information

Title (Eng)
Select or type
If there is no choice for selection, applicant can fill in the information manually

Name (English)

Middle name (English)

Surname (English)

Position

Required documents

1. Passport
2. Additional documents (according to the type of person intended to enter Thailand)
3. Medical insurance (including medical costs in the event that applicant contracts COVID-19, which must cover the total duration)

After all the information are filled in, the system will generate 6-digit code which will be used until the receipt of COE.

Saving information complete

The System has transmitted the application to relevant Embassy/Consulate-General

Please keep this code for obtaining the Certificate of Entry

970186

Very important

Royal Thai Embassy/Consulate-General will pre-approve your documents within 3 working days. After you are pre-approved, please upload your plane ticket, ASQ booking confirmation and other required documents (if any) within 15 days.

go to coethailandmfa.go.th at the Confirmation of Travel Menu

Please note that :

- Air ticket and Alternative State Quarantine (ASQ) booking confirmation must be uploaded to the system within 15 days after your application has been pre-approved.
- If failed to upload the above, the system will automatically cancel your application, and the applicant must start registration process again.

2. Travel confirmation

1

Confirm travel Edit information Check the result

Forgot 6-digit code, click here

Please fill in information for confirmation
Only for air travelers

PASSPORT NUMBER

FIRST NAME

LAST NAME

6-digit code obtained after registration

2 Search Close

3

Attach the evidence of your flight reservation (photo or PDF file of flight reservation)

When your registration is complete, please upload the evidence of your flight reservation within 3 days.

You have time to left:

Day	Hour	Minutes	Second
14	23	55	38

Flight number:

From:

Date of Departure:

Date of Arrival:

After submit travel itinerary, the Royal Thai Embassy and Royal Thai Consulate-General will issue a COE within 3 working days.

3. Information modification and tracking the approval result

- The applicants are able to edit personal information at “Edit information” and track registration status at “Check the result”.

Please fill in information for verification

PASSPORT NUMBER

FIRST NAME

LAST NAME

6-digit code obtained after registration

Search Close

Approval status

Waiting for approval
Your application is under consideration
OK

Approved
Click Download button below to obtain Certificate of Entry
Download

Please note that :

- The information can be modified only
 - When the registration is completed and the embassy/ consulate-general has yet to approve the submitted application, or
 - When the embassy/ consulate-general has rejected the application but allow applicant to modify the information.
- The COE can be received at the “Download” button.

4. The recall of the 6-digit code

In case the applicant forgets the given 6-digit code, it can be recalled as follows.

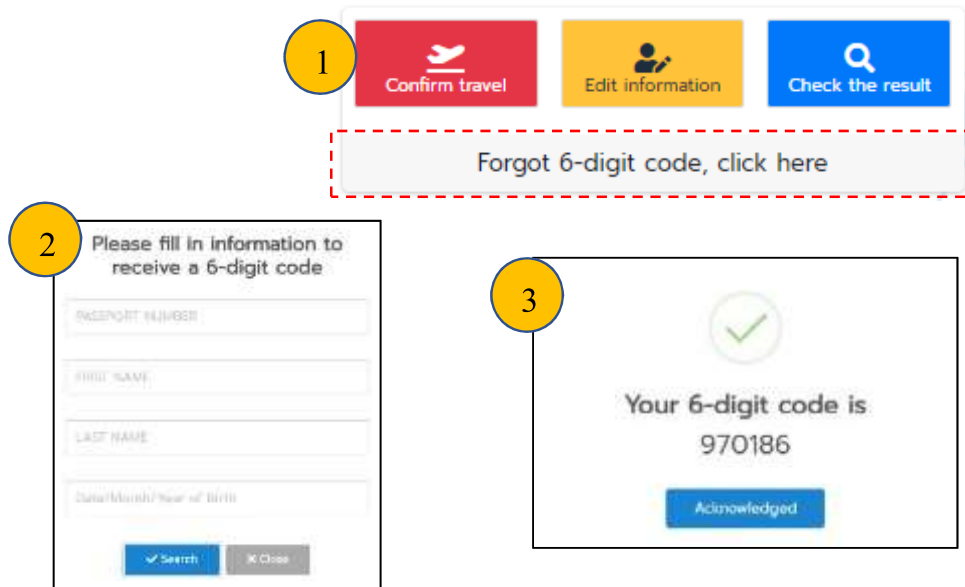

5. Entry to Thailand

5.1 After the receipt of COE, please prepare the additional documents to **declare at the check-in counter** as follows.

- (1) Passport and valid Thai visa/ re-entry permit /APEC card
- (2) Certificate of Entry (COE) (Hard copy)
- (3) a “Fit to Fly” or “Fit to Travel” Health Certificate issued no more than 72 hours before departure (in English)
- (4) a “COVID -free Certificate with RT-PCR method laboratory result” issued no more than 72 hours before departure (in English)
- (5) Insurance policy or letter from employer guaranteeing that the insurance company or employer will cover a minimum of USD 100,000 of medical costs related to COVID-19 during stay in Thailand. (in English or Thai)
- (6) T.8 Form (Thailand’s Health Declaration Form) (download at <https://bit.ly/34X6sAJ>.)

*** Documents (3) (4) (5) must be in English or Thai only. Certified translations into English or Thai are accepted in the case that the original copy is in a foreign language.

5.2 The abovementioned documents in 5.1 must be declared to the immigration and disease control officers once the passenger has arrived in Thailand.

Disease Prevention Measures: Please kindly informed that upon arrival into Thailand, the non-Thai visitors will be subject to 14-days Alternative State Quarantine (ASQ) with their own expenses and will be requested to comply with relevant disease prevention measures prescribed by the Government of Thailand.

* * * * *

List of permitted persons to enter Thailand under Section 9 of the Emergency Decree on Public Administration in Emergency Situations

Category	Description	VISA TYPE
(3)	Persons on diplomatic or consulate missions or under International organizations, or representatives of foreign governments or agencies performing their duties in Thailand, or any other persons in international agencies, that the Ministry of Foreign Affairs gives permission pertaining to necessity, including their spouse, parents, or Children	Diplomatic
(6)	Non-Thai nationals who are spouses, parents, or children of Thai nationals	Non-Immigration O
(7)	Non-Thai nationals who have a certificate of residence, or have been permitted to take up residency in the Kingdom	-
(8)	Non-Thai nationals who have a work permit or have been granted permission to work in the Kingdom in accordance with Thai laws, including their spouses or children	- Non-Immigration B - Non-Immigration O (for spouse/ children)
(9)	Non-Thai nationals who are students of educational establishments in Thailand approved by Thai authorities, including their parents or guardians, except for students of non-formal school in accordance with laws on private schools or of any other similar private educational establishments	- Non-Immigration ED - Non-Immigration O (for parent or guardian)
(10)	Non-Thai nationals who need to receive medical treatment in Thailand, including their accompanying persons, except for treatment for COVID-19	- TR-MT - Non-Immigration O (staying more than 60 days)
(11)	Non-Thai nationals who are permitted to enter the Kingdom under a special arrangement with a foreign country or have been granted permission by the Prime Minister.	- Holder of Thailand Elite visa - Holder of APEC Card - Long Stay (O-A) or (O-X) Visa - Special Tourist Visa (STV) - Tourist (TR) - Non-Immigrant B (Business) - Non-Immigrant O (Retirement)